

**ADELINO**<sup>®</sup>  
— WATER PUMPS —  
— BY —



**Adelino -  
Water pumps**

# ADELINO<sup>®</sup>

— WATER PUMPS —  
— BY —



## Contents

Pressure boosting systems	Page 3
Well pumps	Page 13
Submersible pumps	Page 21
Garden pumps	Page 27

The WITA<sup>®</sup> family also includes the high-end brand ADELINO, which offers water pumps of the highest quality. Innovation and design are the focus at ADELINO. The technology and advanced manufacturing methods of our company make it possible to represent a lifestyle with ADELINO that finds its way into modern living solutions.

**ADELINO: pump it!**



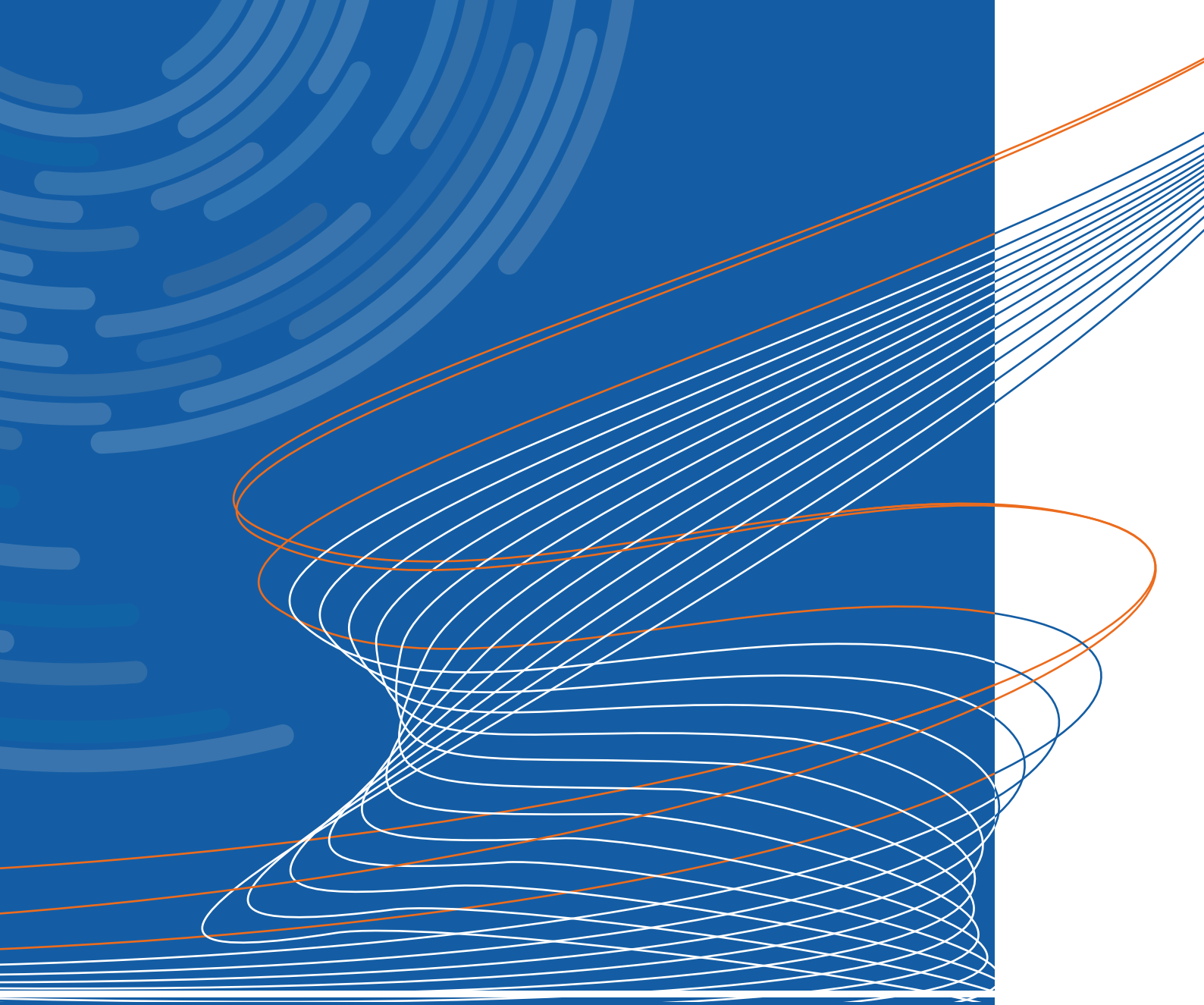

# Pressure boosting systems

# Pressure boosting system CA 600



## Product advantages

- Easy installation and use
- Compact design for easy integration
- Low noise, < 55 dB (A)
- Built-in frequency converter for a constant pressure control
- Dry-run protection

## Applications

- Pressure boosting
- Household water supply



Product movie



- Failure indicators
- Status display
- Pressure adjusting
- Settings
- Pressure adjusting
- On/off

## Technical data

## CA | 600

### Product description

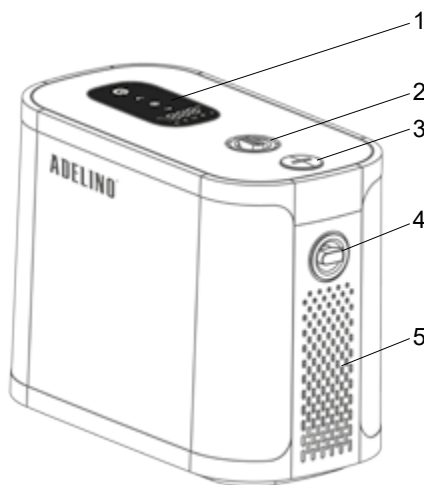

- 1. Operating panel
- 2. Outlet connection
- 3. Priming plug
- 4. Inlet connection
- 5. Ventilation holes

Max. head	45 m
Max. suction head	6 m
Rated power	600 W
Protection class	IP55
Supply voltage	1 × 230V 50/60Hz
Insulation class	F
Pump housing material	PA66-G30
Impeller material	PPO+GF30
Ambient temperature	0 ~ 40°C
Fluid temperature	5 ~ 90°C
Max. system pressure	10 bar
Cable	Length incl. protective power plug 1.5m

**Article No**  
**P OP340 8252**

### Hydraulic characteristics

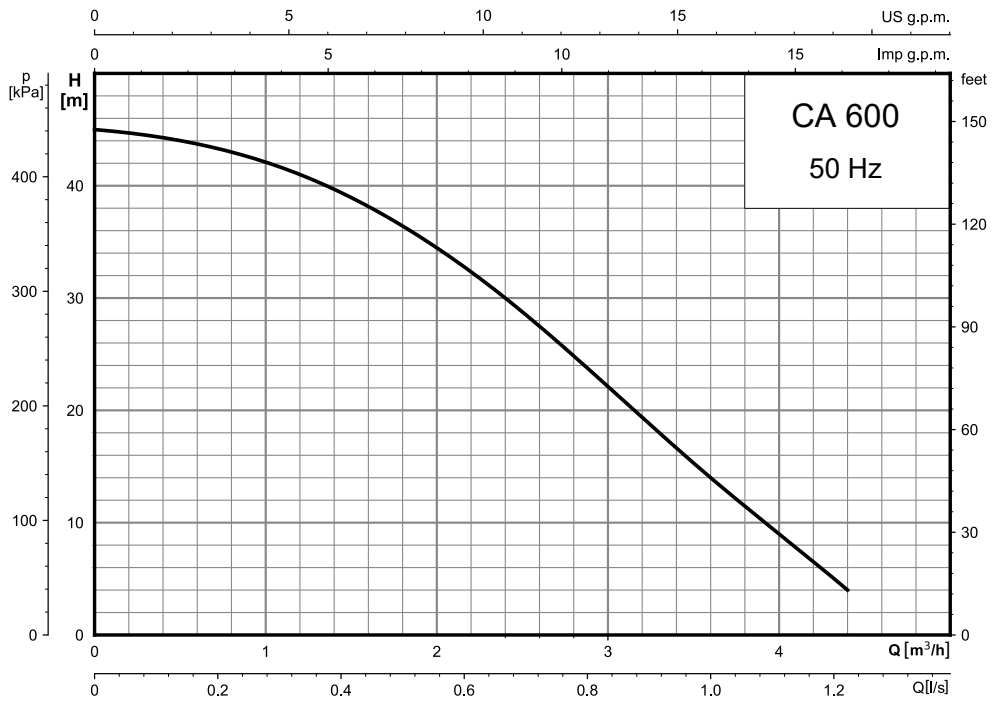

### Dimensions and Weight

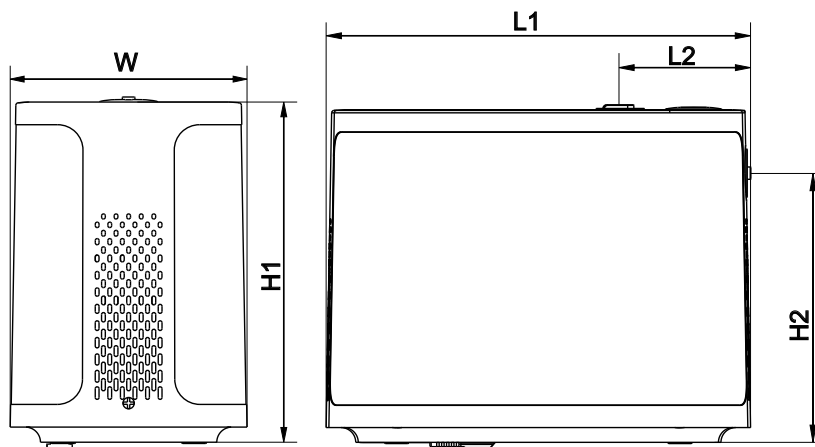

Type	Nominal diameter		Length		Width	Height	
	Suction	Discharge	L1 (mm)	L2 (mm)	W (mm)	H1 (mm)	H2 (mm)
CA600	1"	1"	344.5	101	188	270	206.5

# Pressure boosting system APS-A



## Product advantages

- Compact design: The pump is equipped with a pressure tank, a flow switch and a mechanical pressure switch
- Automatic control and regulation of the water flow through integrated pressure tank, pressure switch and flow control valve
- Reduced operating noise level
- Dry-running protection: Pump switches off automatically if there is no flow at the pump inlet for 6 minutes. After the water flow is restored, the pump restarts automatically

## Technical data

### APS | 55-A

### | 75-A

Max. head (m)	42	50
Max. Flow (m <sup>3</sup> /h)	3	3.4
Max. suction head (m)	8	8
Power P2 (kW)	0.55	0.75
Supply voltage	1x230V, 50Hz	1x230V, 50Hz
Protection class	IPX4	IPX4
Ambient temperature	40°	40°
Fluid temperature	90°	90°
Max. system pressure	5 bar	5 bar
Insulation class	Class B	Class B
Pump housing material	cast iron	cast iron
Impeller material	brass	brass
Cable	1.5m Length incl. protective power plug	1.5m Length incl. protective power plug

**Article No**  
**| P OP340 7463**

**Article No**  
**| P OP340 7464**

### Hydraulic characteristics

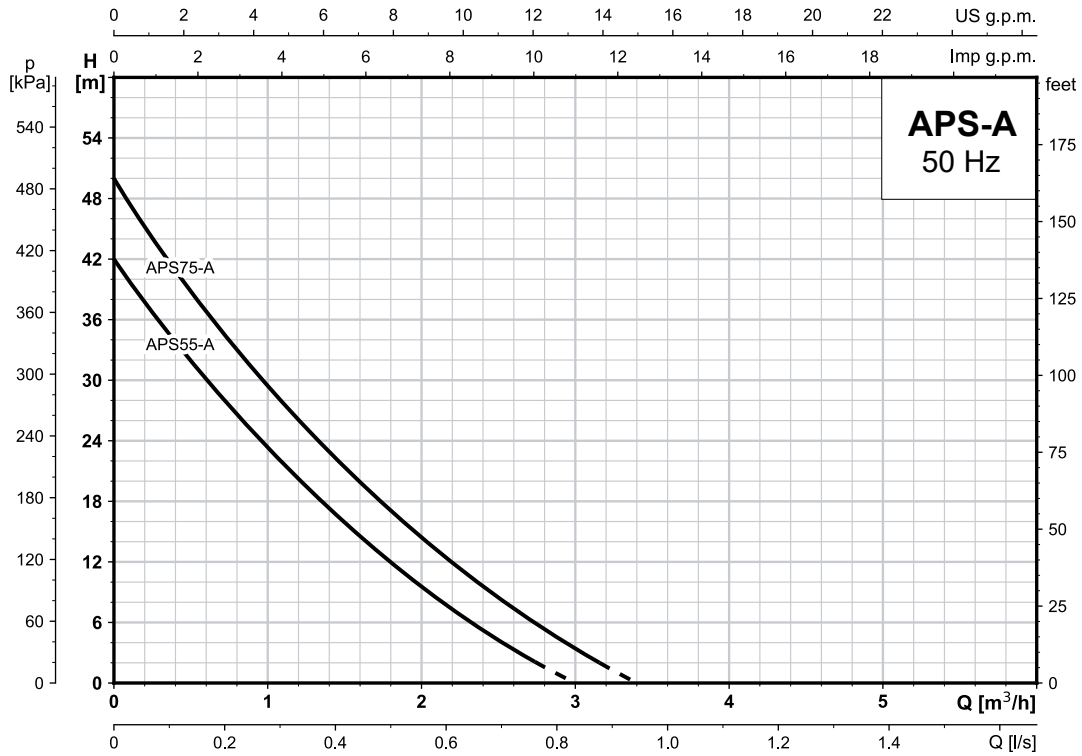

### Dimensions and Weight

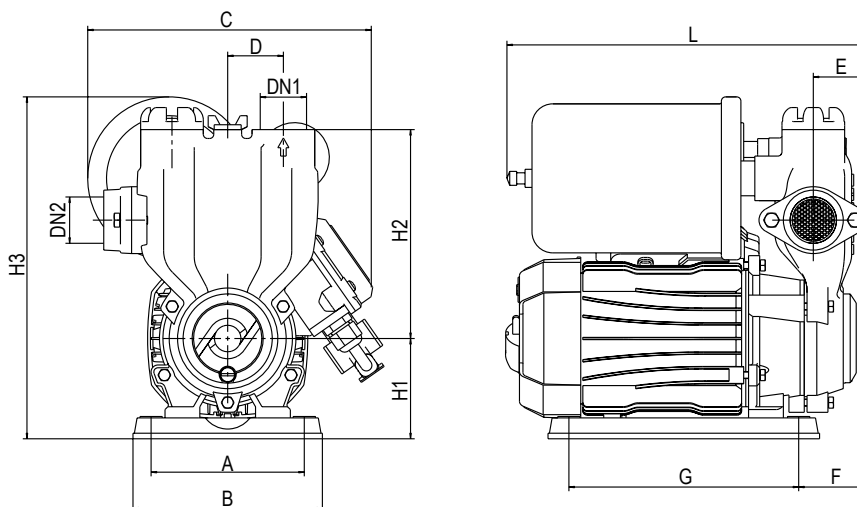

Model	Connections		Dimensions (mm)										Weight (kg)		
	DN1	DN2	A	B	C	D	E	F	G	L	H1	H2	H3	N.W.	G.W.
APS55-A	1"	1"	132	160	212	50	39	41.5	190	268	84	170	285	11.4	12.1
APS75-A	1"	1"	132	160	212	50	39	41.5	190	268	84	170	285	13.1	13.8

# Pressure boosting system APS-C



## Product advantages

- Vertical design of vortex pump and pressure tank with new outer housing for a simple and elegant impression
- Automatic control and regulation of the water flow through integrated pressure tank, pressure switch and flow control valve
- Reduced operating noise level
- Simple and safe installation due to temperature sensor and insulation class F

## Technical data

### APS | 55-C

### | 75-C

Max. head (m)	38	44
Max. Flow (m <sup>3</sup> /h)	3.3	3.6
Max. suction head (m)	6	6
Power P2 (kW)	0.55	0.75
Supply voltage	1x230V, 50Hz	1x230V, 50Hz
Protection class	IPX4	IPX4
Ambient temperature	40°	40°
Fluid temperature	60°	60°
Max. system pressure	5 bar	5 bar
Insulation class	Class F	Class F
Pump housing material	cast iron	cast iron
Impeller material	copper	copper
Cable	1.5m Length incl. protective power plug	1.5m Length incl. protective power plug

**Article No**  
**| P OP340 7473**

**Article No**  
**| P OP340 7474**

## Hydraulic characteristics

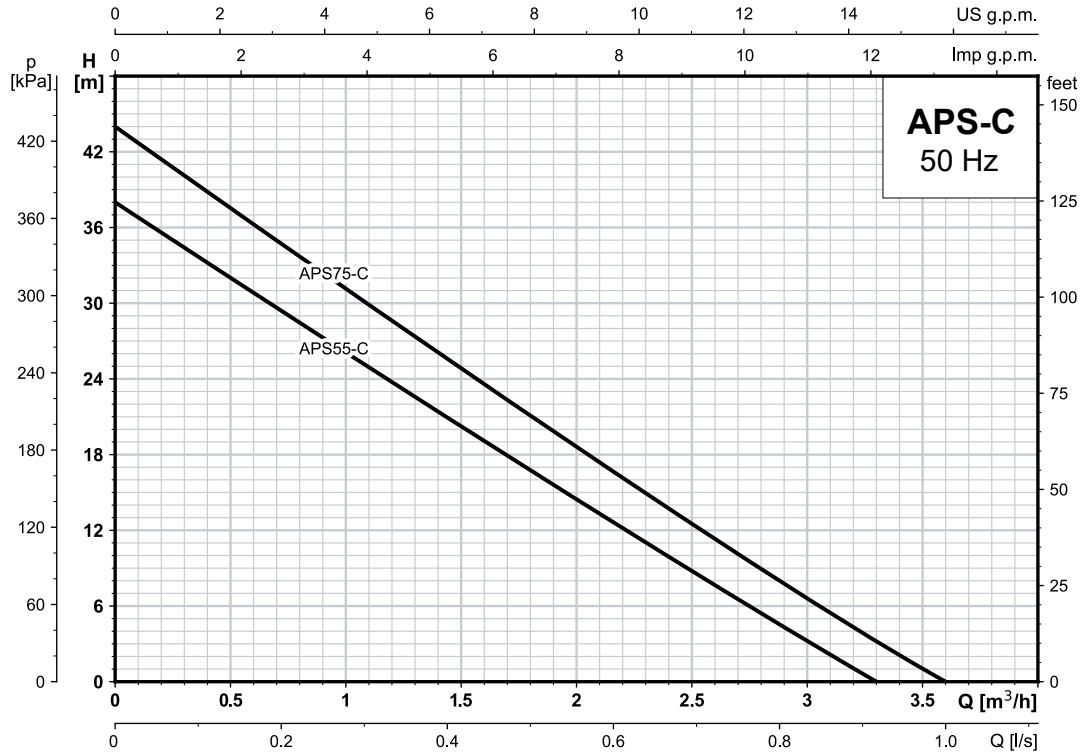

## Dimensions and Weight

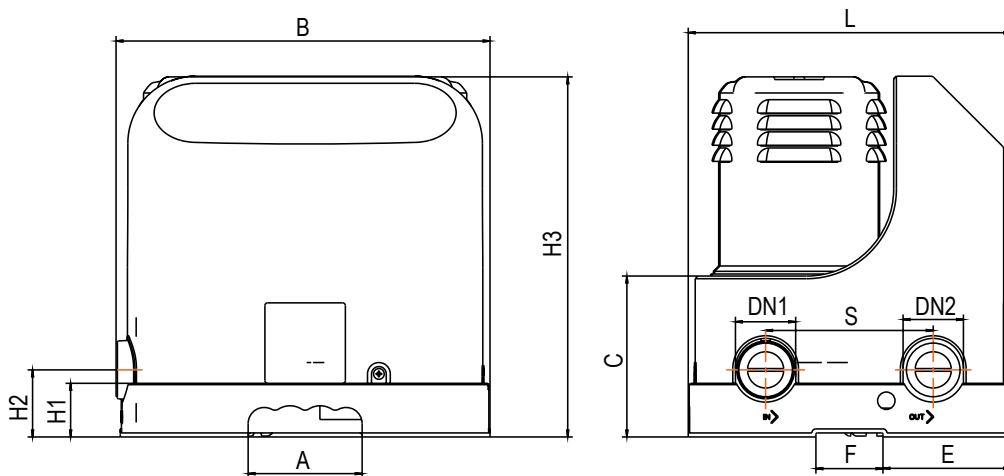

Model	Connections		Dimensions (mm)										Weight (kg)	
	DN1	DN2	A	B	C	E	F	L	H1	H2	H3	S	N.W.	G.W.
Single-phase														
APS55-C	1"	1"	85	305	144	105	60	270	45	56.5	295	155	13.5	14.2
APS75-C	1"	1"	85	305	144	105	60	270	45	56.5	295	155	15.3	16



## Pressure boosting system APS-D

### Product advantages

- Compact design with a pressure tank, a flow switch, an electronic pressure switch and a control unit
- Control unit analyses the data for automatic start-stop function
- 3 -seconds start delay to avoid electrical surges
- Automatic shutdown if there is no flow at the pump inlet for 6 minutes. After the water flow is restored, the pump starts automatically
- Anti-blocking function: If the pump is on standby for 3 days, it runs automatically for approx. 10 seconds to prevent the pump from blocking

### Technical data

#### APS | 55-D

#### | 75-D

Max. head (m)	42	50
Max. Flow (m <sup>3</sup> /h)	3	3.4
Max. suction head (m)	8	8
Power P2 (kW)	0.55	0.75
Supply voltage	1x230V, 50Hz	1x230V, 50Hz
Protection class	IPX4	IPX4
Ambient temperature	40°	40°
Fluid temperature	90°	90°
Max. system pressure	5 bar	5 bar
Insulation class	Class B	Class B
Pump housing material	cast iron	cast iron
Impeller material	brass	brass
Cable	1.5m Length incl. protective power plug	1.5m Length incl. protective power plug

**Article No**  
**| P OP340 7582**

**Article No**  
**| P OP340 7583**

### Hydraulic characteristics

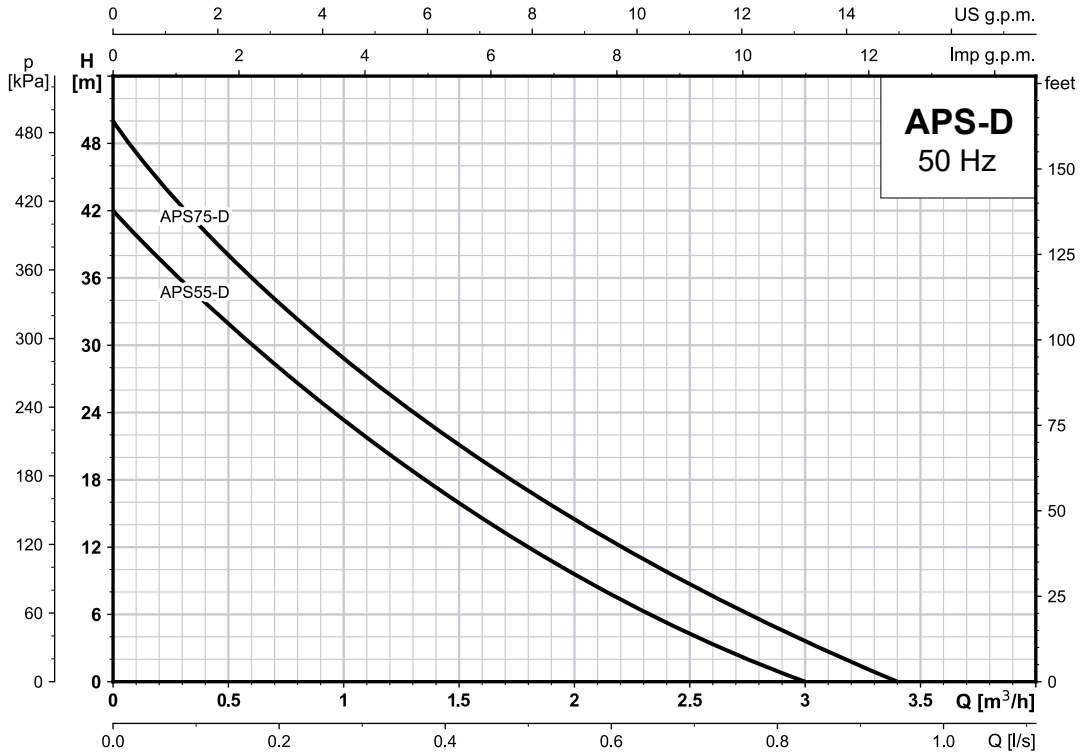

### Dimensions and Weight

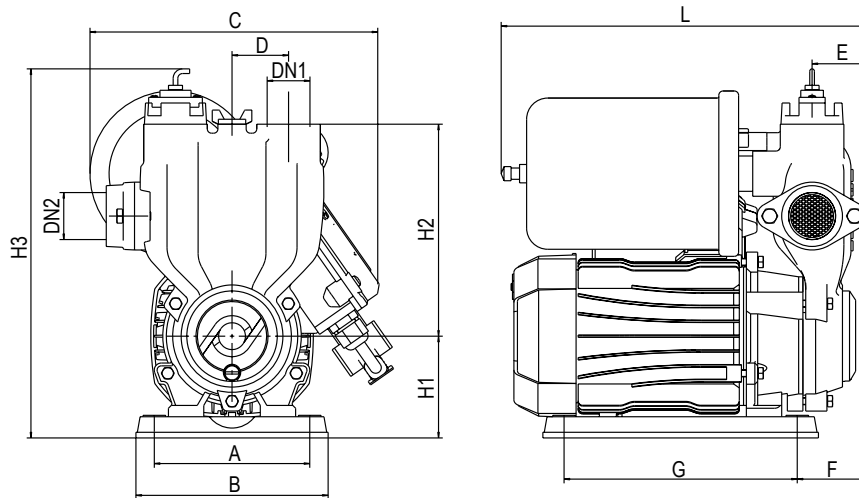

Model	Connections		Dimensions (mm)										Weight (kg)		
	DN1	DN2	A	B	C	D	E	F	G	L	H1	H2	H3	N.W.	G.W.
Single-phase															
APS55-D	1"	1"	132	160	212	50	39	41.5	190	268	84	170	285	11.4	12.1
APS75-D	1"	1"	132	160	212	50	39	41.5	190	268	84	170	285	13.1	13.8

# Pressure switch PS



PS-01

## Product advantages

- Automatically starts and stops the pump
- Stops the pump in case of water shortage
- Starting pressure adjustable
- Easy installation and maintenance free



PS-01A



PS-01B



PS-01C

## Technical data

PS- | 01 | 01A | 01B | 01C

Mains voltage	230 VAC±10%			
Frequency	50/60 Hz			
Current max.	10 A			
Power max.	1.1 kW			
Protection degree	IP65			
Operating pressure max.	10 bar (1.0 MPa)			
Operating temperature max.	55°C			
Male connections	G1"			
Pressure gauge	-	●	●	●
Cable preassembled	-	-	-	●
Dimensions (W x L x H)	225×165×170	155×125×220	105×95×190	240×135×130
	<b>Article No</b> <b>P DS340 8926</b>	<b>Article No</b> <b>P DS340 8927</b>	<b>Article No</b> <b>P DS340 8928</b>	<b>Article No</b> <b>P DS340 8929</b>

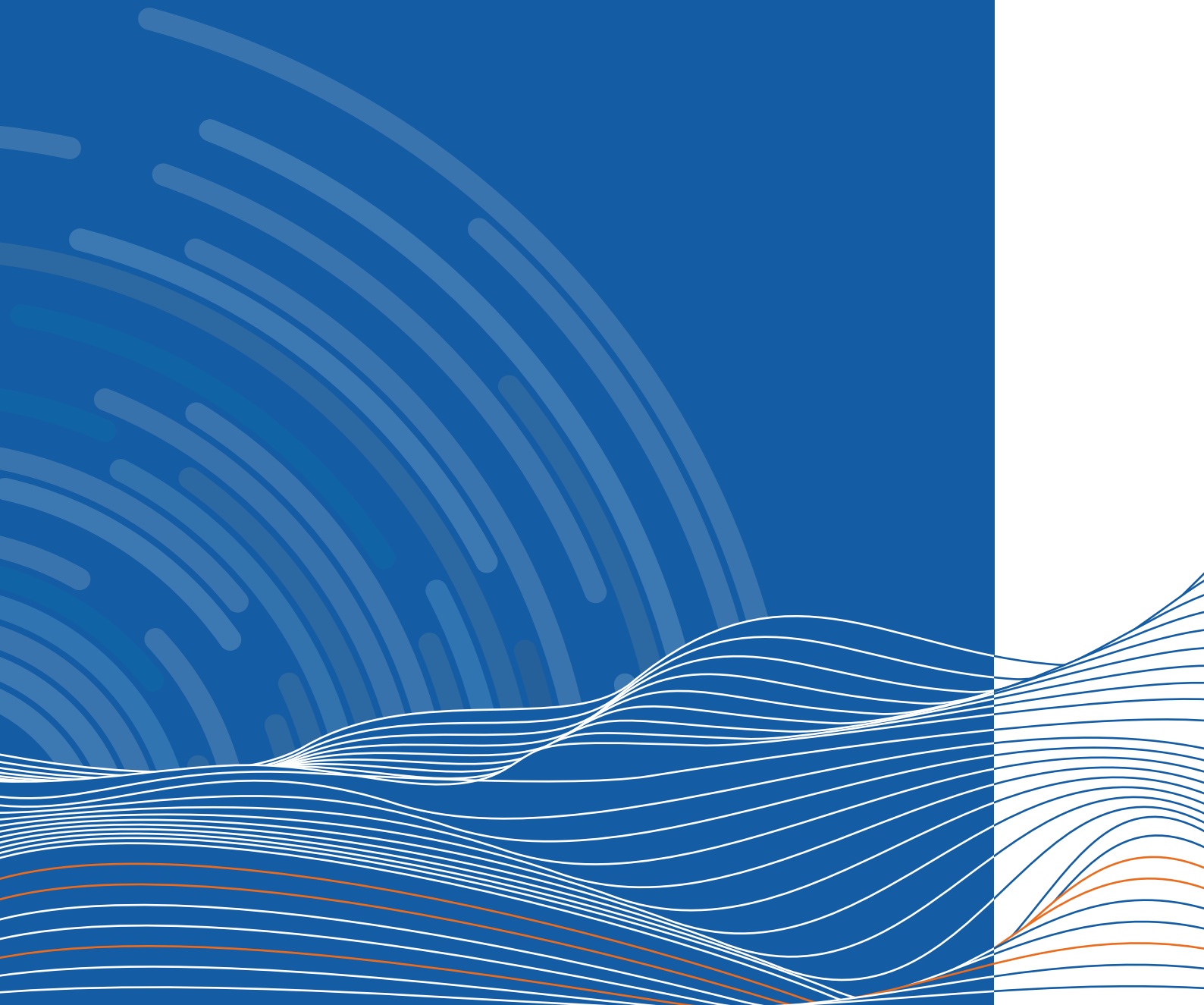

# Well pumps

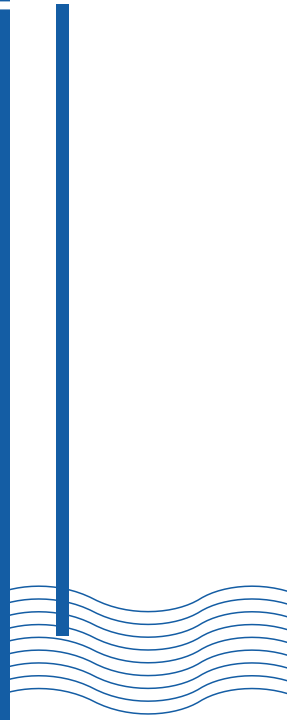



# Well pump 3SAm

## Product advantages

- Optimised new design and improved efficiency
- Easy installation due to low weight and better transport
- Mechanical seal ensures pump reliability
- Compact design and thus space saving enables wide range of application
- The value is characterized by a stainless steel pump housing as well as by the brass connection threads
- External thermal protection against motor overload

## Technical data

**3SAm | 1.8/27-0.75 | 1.8/33-1.1 | 2.5/25-1.1**

Max. head (mH <sub>2</sub> O)	115	142	104
Max. Flow (m <sup>3</sup> /h)	2.7	2.7	3.6
Power P2 (kW)	0.75	1.1	1.1
Supply voltage	1x230V, 50Hz	1x230V, 50Hz	1x230V, 50Hz
Current	6	8.4	8.4
Protection class	IPX8	IPX8	IPX8
Fluid temperature (°C)	40	40	40
Max. immersion depth (m)	70	70	70
Insulation class	Class B	Class B	Class B
Pump housing material	stainless steel	stainless steel	stainless steel
Impeller material	POM	POM	POM
Cable	25m Length incl. protective power plug	25m Length incl. protective power plug	25m Length incl. protective power plug
Motor	Ediable oil filled motor	Ediable oil filled motor	Ediable oil filled motor

**Article No**  
**P BP340 7204**

**Article No**  
**P BP340 7205**

**Article No**  
**P BP340 7211**

Different product types available on request.  
Contact for the details.

**Hydraulic characteristics**

**Dimensions and Weight**

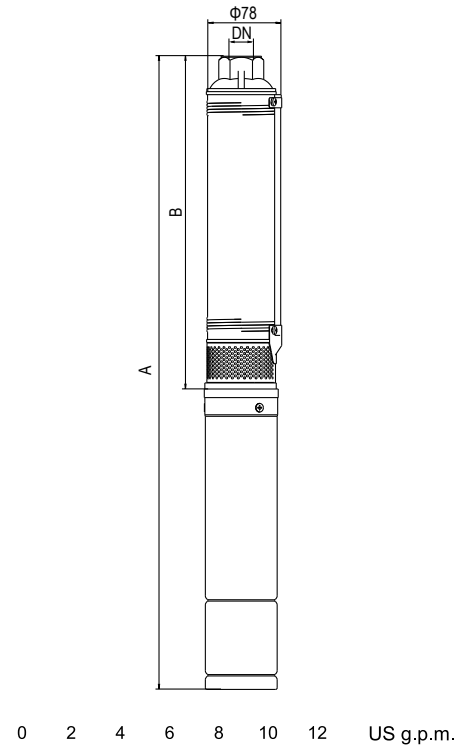
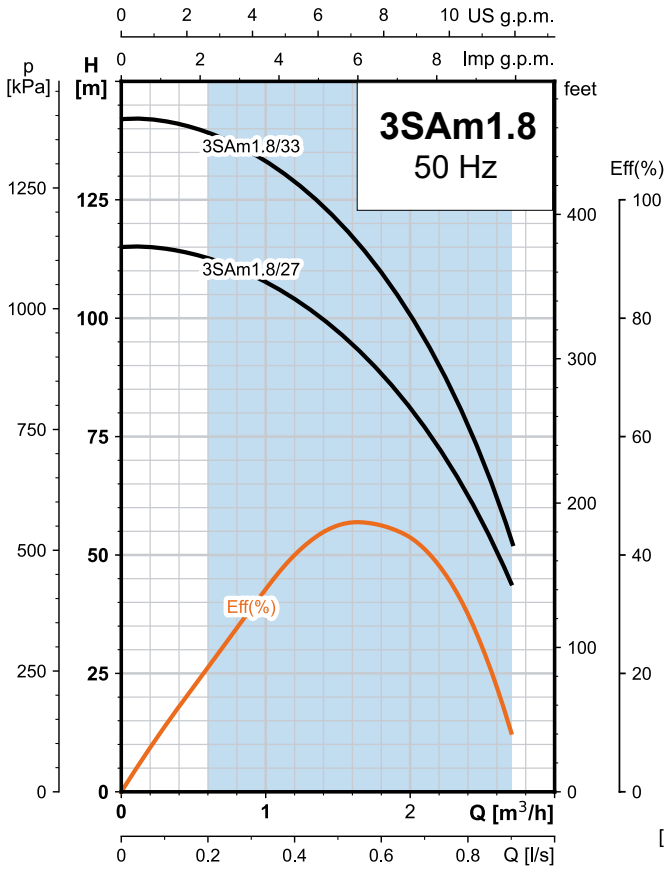

Model	Connections	Dimensions (mm)		Weight (kg)	
		A	B	N.W.	G.W.
Single-phase	DN				
3SAm1.8/27	1"	1255	831	12	13
3SAm1.8/33	1"	1475	966	14.5	15.5
3SAm2.5/25	1"	1425	916	13	14

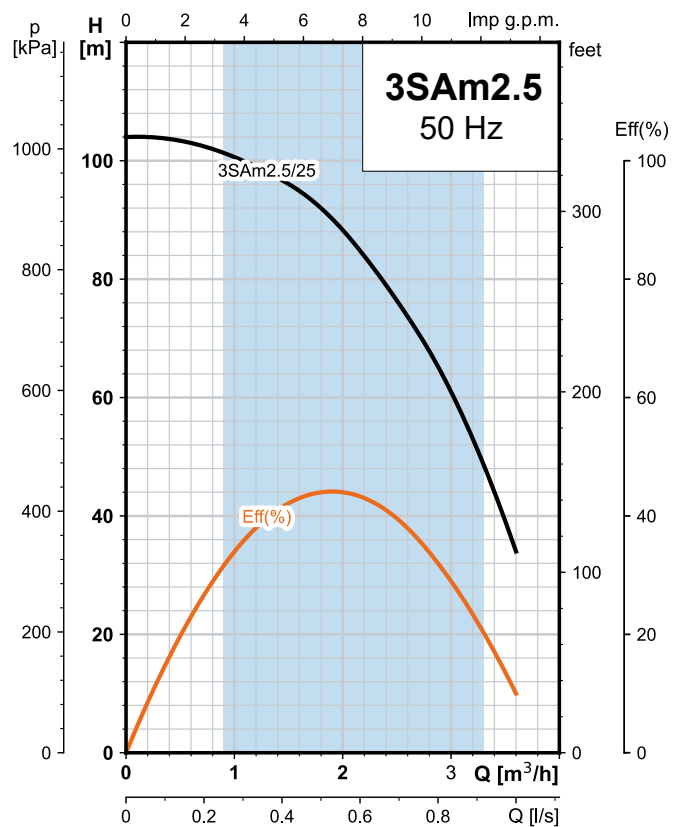



## Well pump 4SAm

### Product advantages

- Optimised new design and improved efficiency
- Wide product range from 2 m<sup>3</sup>/h to 16 m<sup>3</sup>/h for the most diverse application requirements
- Mechanical seal ensures pump reliability
- New anti-sand structure of the motor for high sand resistance and long service life
- The value is characterized by a stainless steel pump housing as well as by the brass connection threads
- External thermal protection against motor overload
- Automatic pressure regulation mechanism to balance the pressure inside and outside the motor and increase the immersion depth

### Technical data

#### 4SAm | 2/8-0.37 | 2/16-0.75 | 2/28-1.5

Max. head (mH <sub>2</sub> O)	58	117	206
Max. Flow (m <sup>3</sup> /h)	3.6	3.6	3.6
Power P2 (kW)	0.37	0.75	1.5
Supply voltage	1x230V, 50Hz	1x230V, 50Hz	1x230V, 50Hz
Current	4.2	6.9	12.2
Protection class	IPX8	IPX8	IPX8
Fluid temperature (°C)	40	40	40
Max. immersion depth (m)	70	70	70
Insulation class	Class B	Class B	Class B
Pump housing material	stainless steel	stainless steel	stainless steel
Impeller material	POM	POM	POM
Cable	25m Length incl. protective power plug	25m Length incl. protective power plug	25m Length incl. protective power plug
Motor	Ediable oil filled motor	Ediable oil filled motor	Ediable oil filled motor

**Article No**  
**P BP340 7263**

**Article No**  
**P BP340 7266**

**Article No**  
**P BP340 7270**

Different product types available on request.  
Contact for the details.

## Hydraulic characteristics

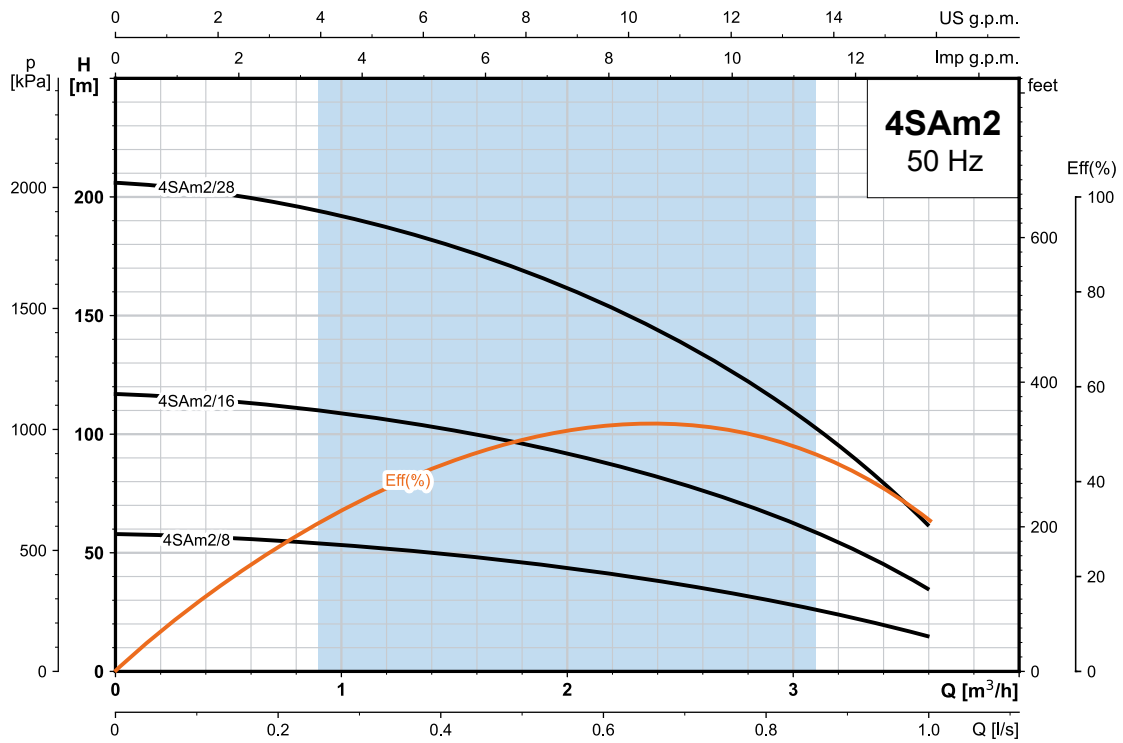

## Dimensions and Weight

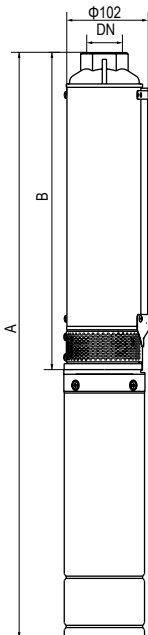

Model	Connections	Dimensions (mm)		Weight (kg)	
		A	B	N.W.	G.W.
<b>Single-phase</b>	DN				
4SAm2/8	1¼"	715	391	12.2	13.7
4SAm2/16	1¼"	959	590	16	17.5
4SAm2/25	1¼"	1333	884	M:15 P:6.8	M:17 P:7.8
4SAm2/28	1¼"	1407	958	M:15 P:7.4	M:17 P:8.4



# Well pump NAm

## Product advantages

- Excellent thermal performance due to internally mounted motor, good heat dissipation and effective control of the temperature rise range
- Integrated thermal protection and intelligent temperature sensing for effective coil protection
- Impeller made of high temperature resistant material to ensure long and reliable operation
- Structural design ensures reliable sealing and easy maintenance
- High quality and corrosion resistant stainless steel pump housing
- Durability in sediment-laden environments due to the impeller strand fixed as a whole and the radially sealed impeller ring

## Technical data

### NAm | 3/6

### | 3/8

Max. head (mH <sub>2</sub> O)	66	88
Max. Flow (m <sup>3</sup> /h)	5.4	5.4
Power P2 (kW)	1.1	1.5
Supply voltage	1x230V, 50Hz	1x230V, 50Hz
Current	8.4	10.9
Protection class	IPX8	IPX8
Fluid temperature (°C)	40	40
Max. immersion depth (m)	20	20
Insulation class	Class B	Class B
Pump housing material	stainless steel	stainless steel
Impeller material	PPO + GF30	PPO + GF30
Cable	25m Length incl. protective power plug	25m Length incl. protective power plug
Motor	Ediable oil filled motor	Ediable oil filled motor

**Article No**  
**| P BP340 7188**

**Article No**  
**| P BP340 7189**

## Hydraulic characteristics

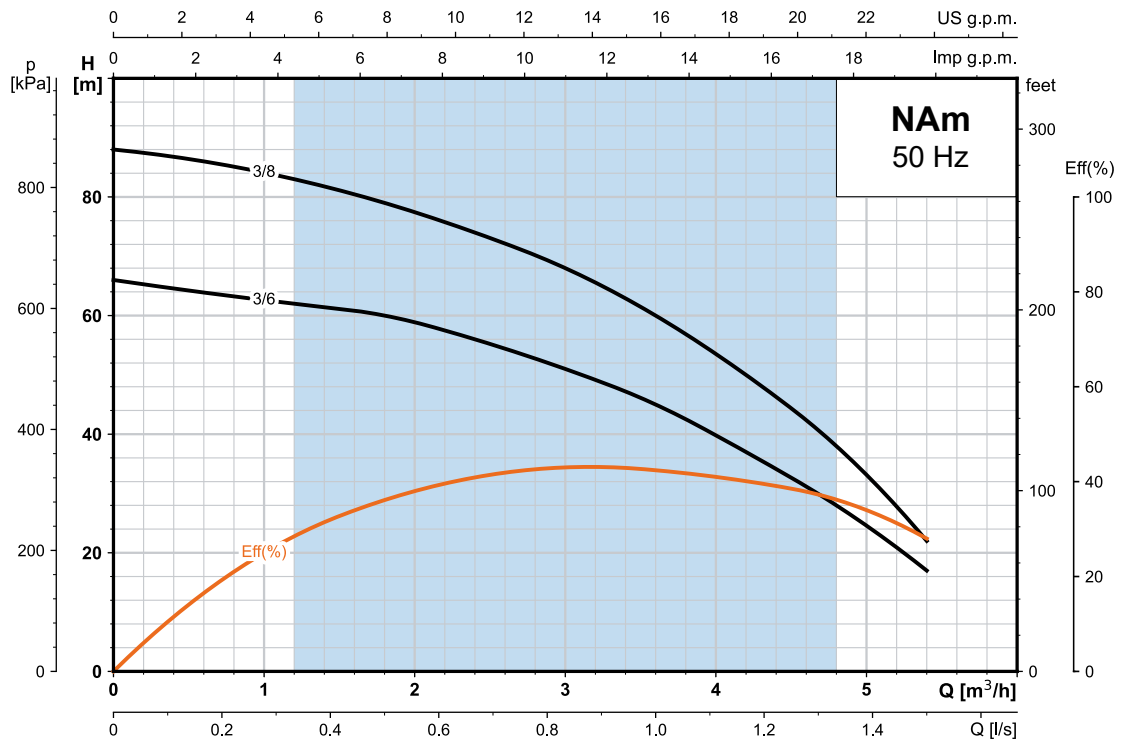

## Dimensions and Weight



Model	Connections	Dimensions (mm)	Weight (kg)	
			N.W.	G.W.
<b>Single-phase</b>	DN	A		
NAm3/6	1¼"	690	19	20
NAm3/8	1¼"	780	22.5	24

# ADELINO<sup>®</sup>

— WATER PUMPS —

— BY —





# Submersible pumps

# Submersible pump QDX



## Product advantages

- Durable and wear-resistant due to plastic impeller
- Built-in overload protection
- Double mechanical seal and improved cable seal design
- Long service life due to cast iron pump body, treated with electrophoresis technology, sand- and corrosion resistant
- NOW NEW: with 10 m connection cable

## Technical data

### QDX | 10-12-0.55K3-F

### | 1.5-32-0.75K3-F

Max. head (m)	17	34
Max. Flow (m <sup>3</sup> /h)	18	6.5
Power P2 (kW)	0.55	0.75
Supply voltage	1x230V, 50Hz	1x230V, 50Hz
Protection class	IPX8	IPX8
Fluid temperature (°C)	40	40
Immersion depth (m)	0.5-5	0.5-5
Insulation class	B	B
Pump housing material	cast iron	cast iron
Impeller material	PPO + GF30	PPO + GF30
Cable (m)	10m Length incl. protective power plug	10m Length incl. protective power plug

**Article No**  
**| P TP340 7551**

**Article No**  
**| P TP340 7102**

### Hydraulic characteristics

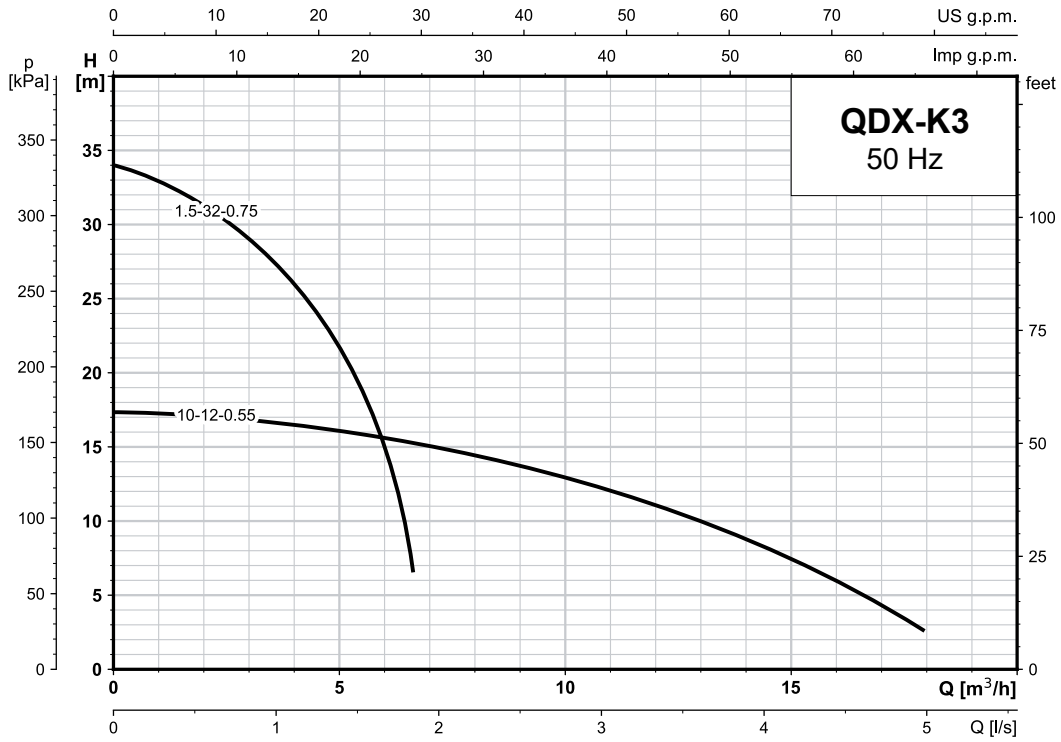

### Dimensions and Weight

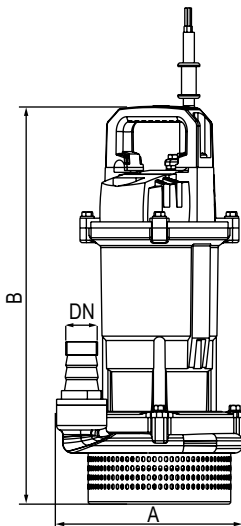

Model	Connections	Dimensions (mm)		Weight (kg)	
		A	B	N.W.	G.W.
QDX1.5-32-0.75-K3	1"	235	390	12	12.5
QDX10-12-0.55-K3	1½"	230	370	11	11.5

# Submersible sewage pump WVSD



## Product advantages

- Durability and stability due to stainless steel housing and stainless steel screws
- High performance: The open impeller type contributes to a better flowability of the wastewater
- Reliable sealing: With double mechanical seal on both sides of the stainless steel shaft, a more reliable sealing performance is achieved

## Technical data

### WVSD | 55F | 75F | 110F | 150F

	55F	75F	110F	150F
Max. head (m)	10	12	13	14
Max. Flow (m <sup>3</sup> /h)	18	21	27	30
Power P2 (kW)	0.55	0.75	1.1	1.5
Supply voltage	1x230V, 50Hz	1x230V, 50Hz	1x230V, 50Hz	1x230V, 50Hz
Protection class	IPX8	IPX8	IPX8	IPX8
Fluid temperature (°C)	40	40	40	40
Immersion depth (m)	0.5-5	0.5-5	0.5-5	0.5-5
Insulation class	B	B	B	B
Pump housing material	cast iron	cast iron	cast iron	cast iron
Impeller material	PPO + GF20	PPO + GF20	PPO + GF20	PPO + GF20
Cable (m)	10 m Length incl.   protective power plug	10 m Length incl.   protective power plug	10 m Length incl.   protective power plug	10 m Length incl.   protective power plug
	<b>Article No</b> <b>  P TP340 7105</b>	<b>Article No</b> <b>  P TP340 7106</b>	<b>Article No</b> <b>  P TP340 7108</b>	<b>Article No</b> <b>  P TP340 7109</b>

Different product types available on request.  
Contact for the details.

## Hydraulic characteristics

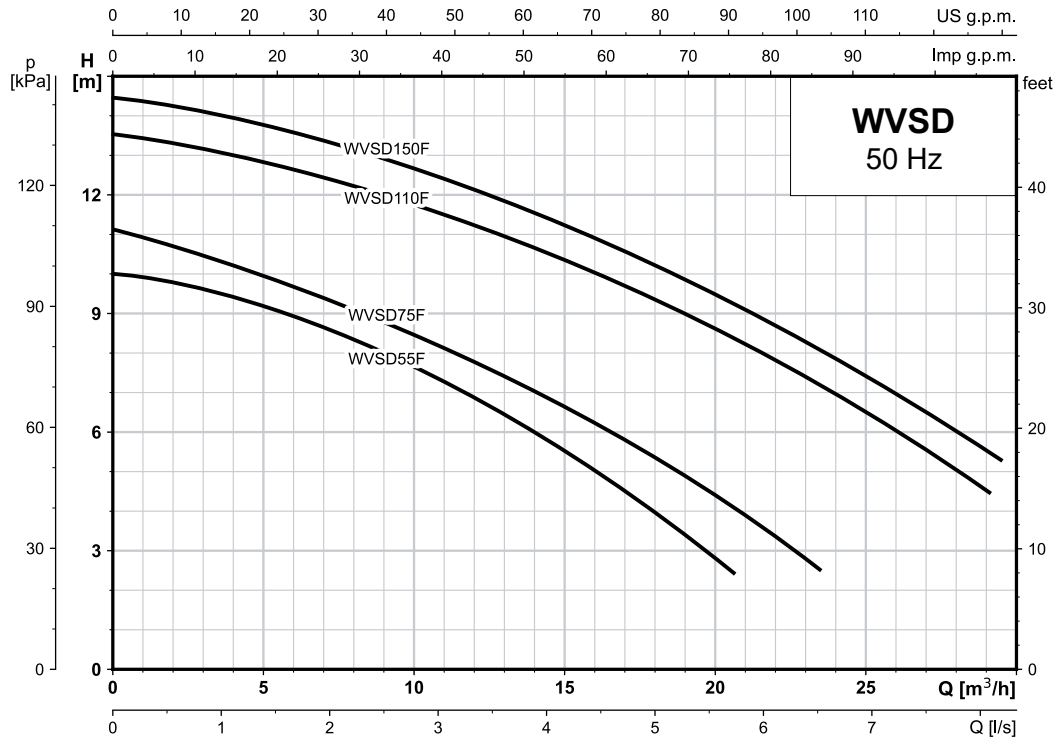

## Dimensions and Weight

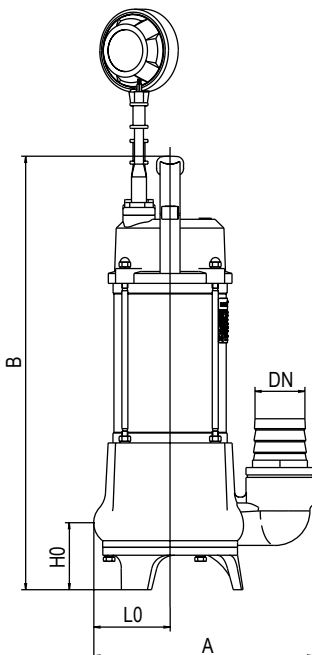

Model	Connections	Dimensions (mm)				Weight (kg)	
		A	B	L0	H0	N.W.	G.W.
WVSD55F	2"	220	440	79	67	16	17
WVSD75F	2"	220	460	79	67	18	19
WVSD110F	2"	245	475	90	83	22	23
WVSD150F	2"	245	500	90	83	24	25.5



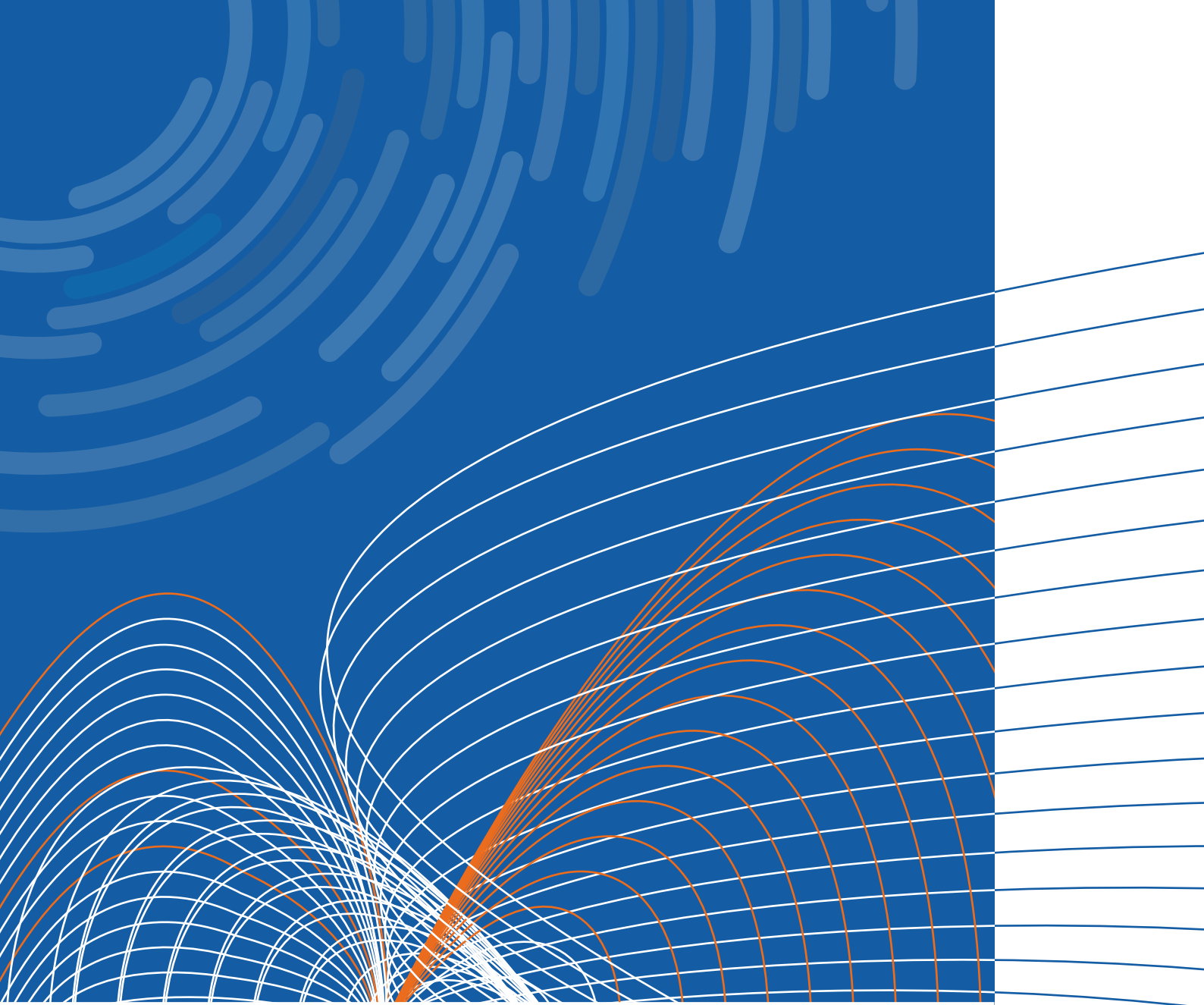

# Garden pumps

# Centrifugal pump HPm



## Product advantages

- Multi-stage centrifugal design for higher outlet pressure and higher efficiency
- Self-priming function with external pressure switch for automatic control
- Pump housing made of grey cast iron /stainless steel; the cast iron parts in contact with water are treated with electrophoresis technology
- Better overload protection of the motor due to insulation class EN 60085

## Technical data

### HPm | 203

### | 204

Max. head (m)	32	42
Max. Flow (m <sup>3</sup> /h)	5.4	5.4
Max. suction head (m)	7	7
Power P2 (kW)	0.37	0.55
Supply voltage	1x230V, 50Hz	1x230V, 50Hz
Protection class	IPX4	IPX4
Ambient temperature (°C)	40	40
Fluid temperature (°C)	40	40
Max. system pressure (bar)	4.5	4.5
Insulation class	Class F	Class F
Pump housing material	Cast iron/Stainless steel	Cast iron/Stainless steel
Impeller material	PPO + GF30	PPO + GF30
Cable	1.5m Length incl. protective power plug	1.5m Length incl. protective power plug

**Article No**  
**| P OP340 7145**

**Article No**  
**| P OP340 7146**

### Hydraulic characteristics

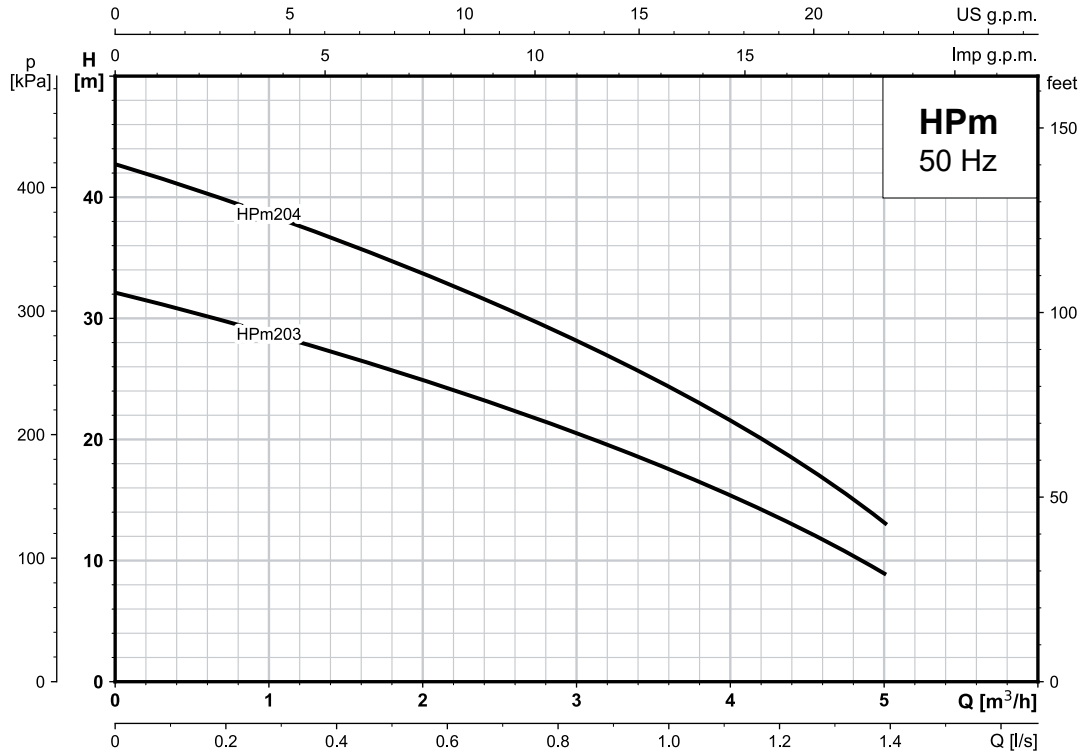

### Dimensions and Weight

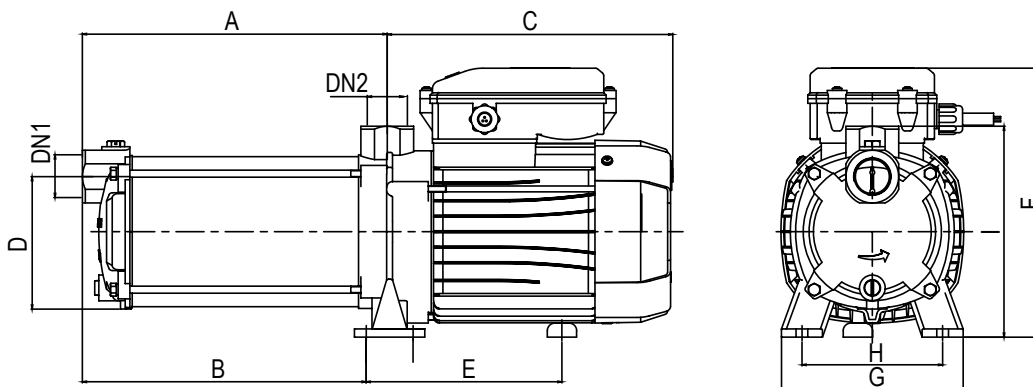

Model	Connections		Dimensions (mm)									Weight (kg)	
	DN1	DN2	A	B	C	D	E	F	G	H	I	N.W.	G.W.
Single-phase HPm203	1"	1"	187	236.5	212	110	74	170	140	102	150.5	9.5	10.5
HPm204	1"	1"	213	262.5	212	110	74	170	140	102	150.5	10.5	11.5

# Centrifugal pump ACm



## Product advantages

- Innovative design, optimised engine - and hydraulic performance

## Technical data

### ACm | 75

Max. head (m)	32
Max. Flow (m <sup>3</sup> /h)	7.2
Max. suction head (m)	7
Power P2 (kW)	0.75
Supply voltage	1x230V, 50Hz
Protection class	IP44
Ambient temperature (°C)	40
Fluid temperature (°C)	40
Max. system pressure (bar)	6
Insulation class	Class B
Pump housing material	cast iron
Impeller material	stainless steel
Cable	1.5m Length incl. protective power plug

**Article No**  
**| P OP340 7504**

### Hydraulic characteristics

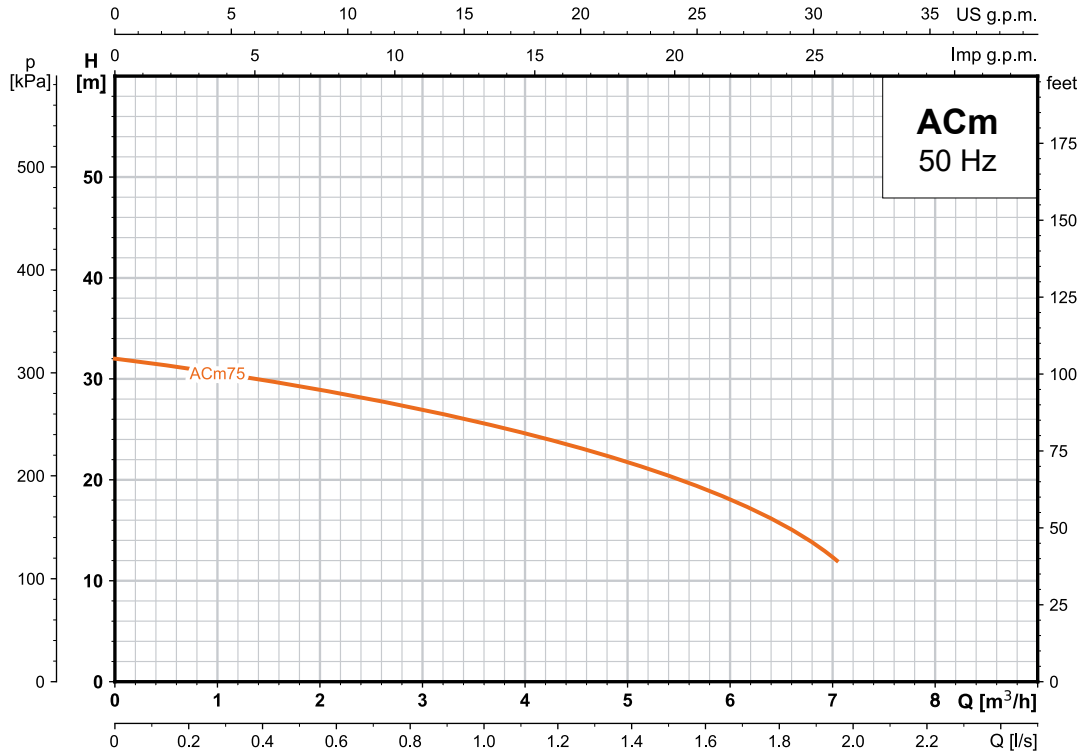

### Dimensions and Weight

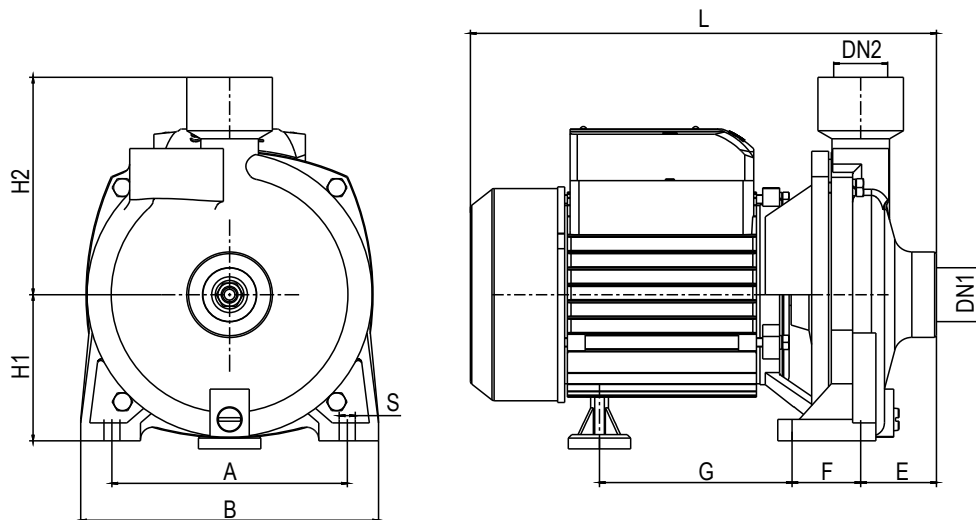

Model	Connections		Dimensions (mm)									Weight (kg)	
	DN1	DN2	A	B	E	F	G	L	S	H1	H2	N.W.	G.W.
Single-phase ACm75	1"	1"	140	182	47	38	112	294	10	100	144	13.5	13.8

# Centrifugal pump ACm



## Product advantages

- Innovative design, optimised engine - and hydraulic performance

## Technical data

### ACm | 75B1.5

Max. head (m)	17
Max. Flow (m <sup>3</sup> /h)	18
Max. suction head (m)	7
Power P2 (kW)	0.75
Supply voltage	1x230V, 50Hz
Protection class	IP44
Ambient temperature (°C)	40
Fluid temperature (°C)	40
Max. system pressure (bar)	3
Insulation class	Class B
Pump housing material	cast iron
Impeller material	copper
Cable	1.5m Length incl. protective power plug

**Article No**  
**| P OP340 7509**

### Hydraulic characteristics

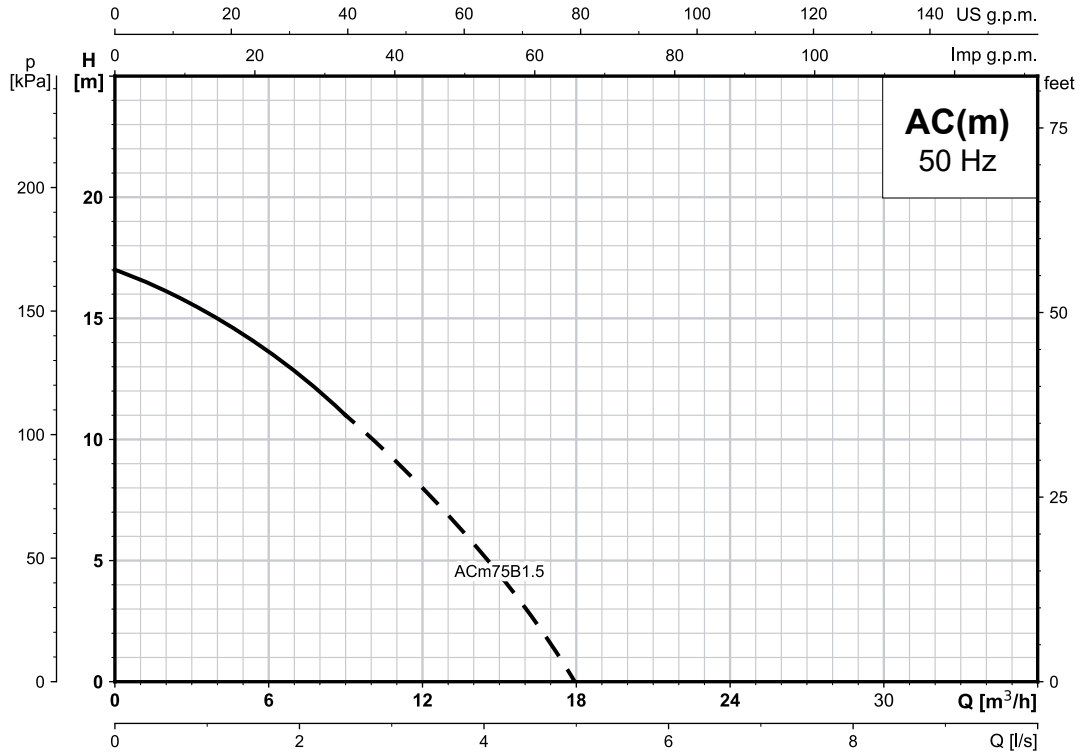

### Dimensions and Weight

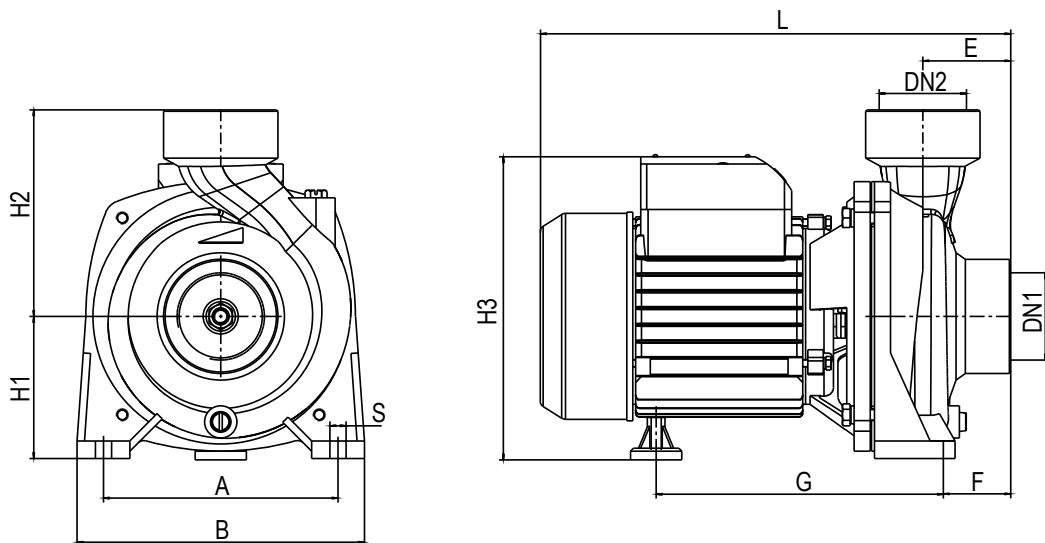

Model	Connections		Dimensions (mm)										Weight (kg)	
	DN1	DN2	A	B	E	F	G	L	S	H1	H2	H3	N.W.	G.W.
ACm75B1.5	1½"	1½"	160	190	41	91	129	299	10	95	135	204	10.5	11

# Centrifugal pump HSm



## Product advantages

- Multi-stage centrifugal design for higher outlet pressure and higher efficiency
- Pump housing made of stainless steel, hydraulic components such as the impeller made of glass-fibre reinforced plastic
- Automatic control: with an external pressure switch, a constant pressure of supplied water can be achieved

## Technical data

### HSm | 404

Max. head (m)	45
Max. Flow (m <sup>3</sup> /h)	9
Max. suction head (m)	7
Power P2 (kW)	0.75
Supply voltage	1x230V, 50Hz
Protection class	IP44
Ambient temperature (°C)	40
Fluid temperature (°C)	40
Max. system pressure (bar)	4.8
Insulation class	Class B
Pump housing material	stainless steel
Impeller material	PPO + GF30
Cable	1.5m Length incl. protective power plug

**Article No**  
**| P OP340 7482**

### Hydraulic characteristics

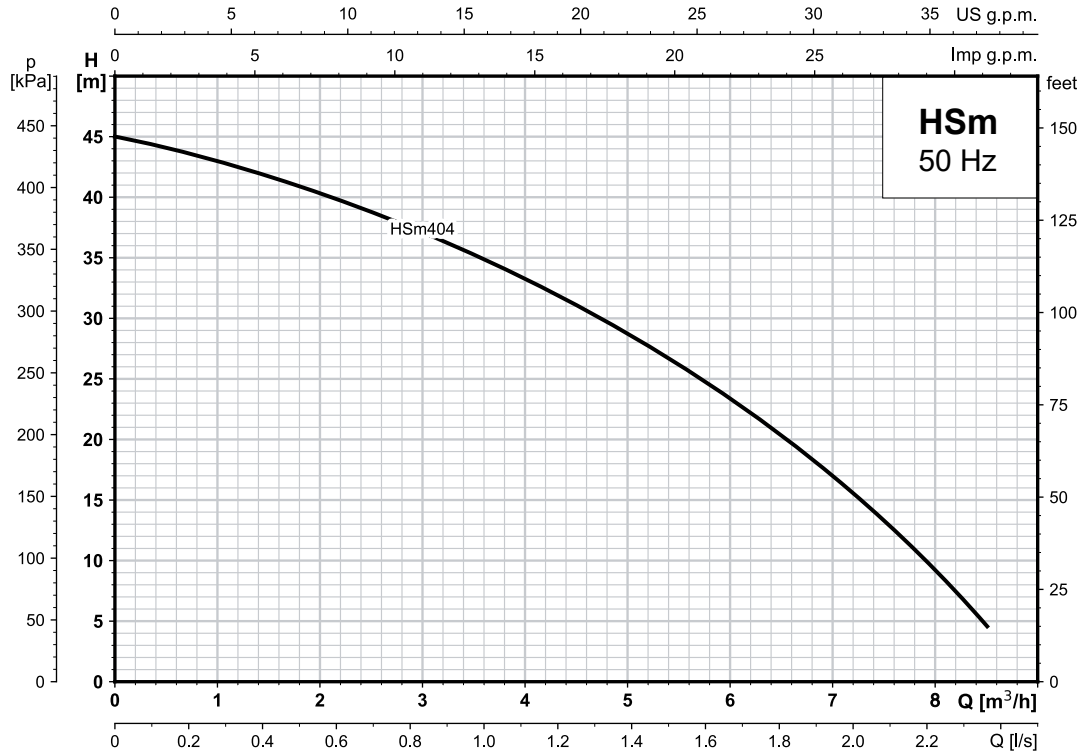

### Dimensions and Weight

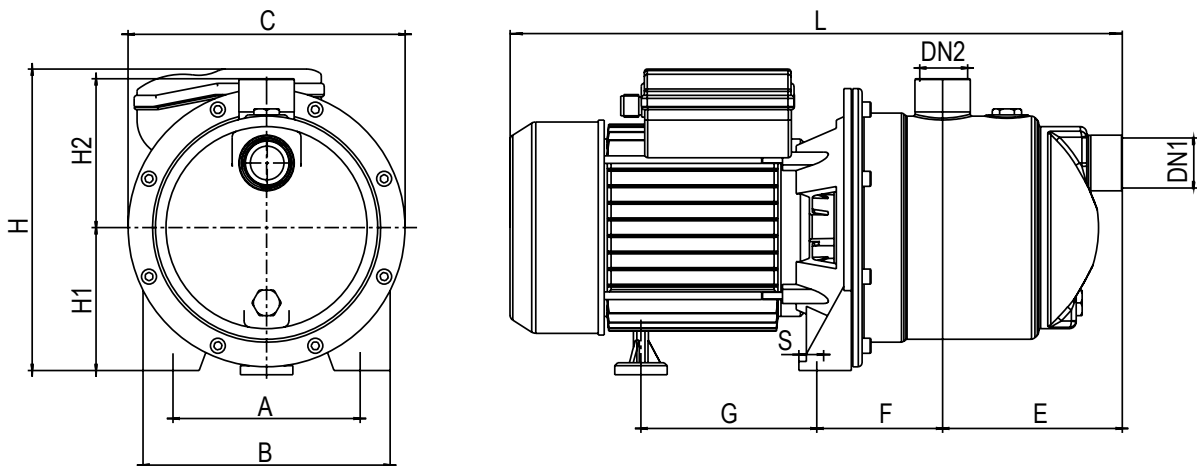

Model	Connections		Dimensions (mm)										Weight (kg)		
	DN1	DN2	A	B	C	E	F	G	L	S	H1	H2	H	N.W.	G.W.
Single-phase HSm404	1"	1"	125	165	185	120	84	117.5	409	9	95	99	204	11	11.5

# Jet pump AJ-A



## Product advantages

- Jet pump with brass impeller, PPO nozzle unit and pump body made of cast iron
- Configurable: for automatic control, the pump can also be supplied with a pressure switch and pressure tank

## Technical data

### AJ | 55-A

### | 75-A

### | 110-A

Max. head (m)	41	46	52
Max. Flow (m <sup>3</sup> /h)	3.6	4.5	5.4
Max. suction head (m)	9	9	9
Power P2 (kW)	0.55	0.75	1.1
Supply voltage	1x230V, 50Hz	1x230V, 50Hz	1x230V, 50Hz
Protection class	IP44	IP44	IP44
Ambient temperature (°C)	40	40	40
Fluid temperature (°C)	40	40	40
Max. system pressure (bar)	6	6	6
Insulation class	Class B	Class B	Class B
Pump housing material	cast iron	cast iron	cast iron
Impeller material	copper	copper	copper
Cable	1.5m Length incl. protective power plug	1.5m Length incl. protective power plug	1.5m Length incl. protective power plug

**Article No**  
**| P OP340 7165**

**Article No**  
**| P OP340 7166**

**Article No**  
**| P OP340 7167**

## Hydraulic characteristics

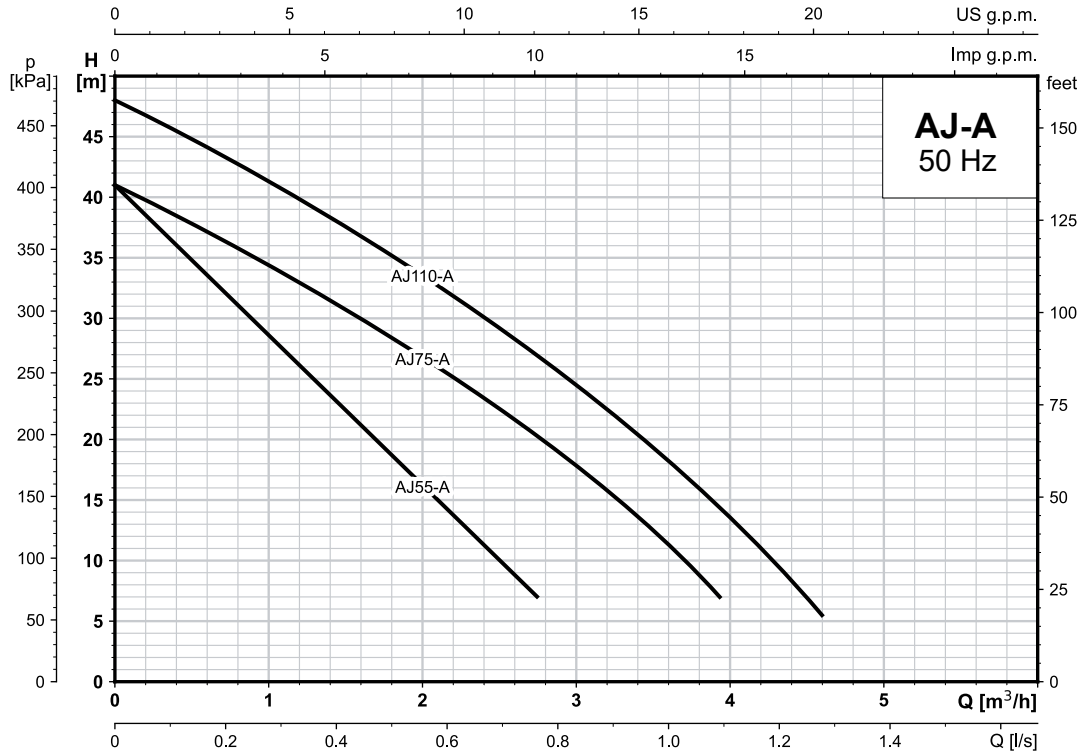

## Dimensions and Weight

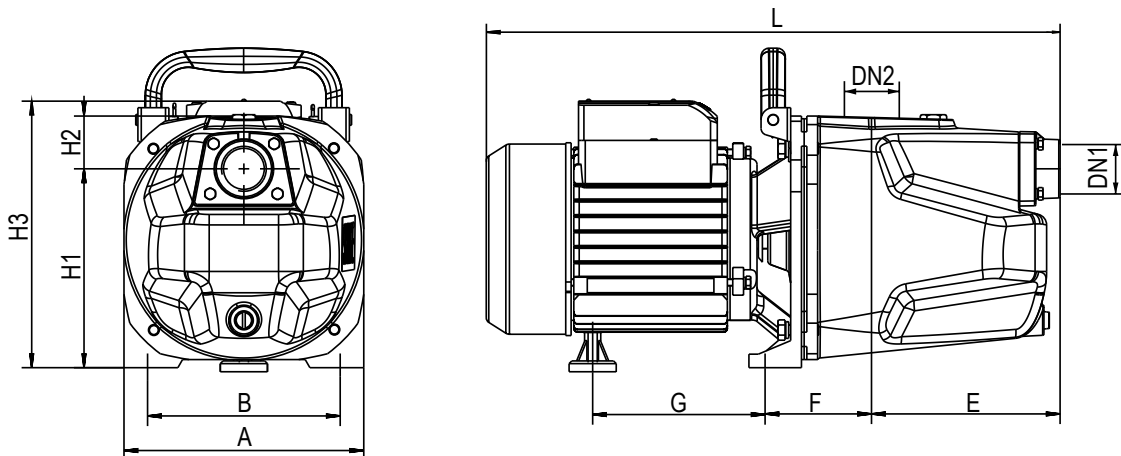

Model	Connections		Dimensions (mm)									Weight (kg)	
	DN1	DN2	A	B	E	F	G	L	H1	H2	H3	N.W.	G.W.
Single-phase													
AJ55-A	1"	1"	140	178	132	21	193	430	147	38	204	13.3	14
AJ75-A	1"	1"	140	178	132	21	193	430	147	38	204	14.7	15.5
AJ110-A	1"	1"	140	178	132	21	193	430	147	38	204	15.7	16.5

# Jet pump AJ-S



## Product advantages

- New design with stainless steel pump housing
- Jet pump with PPO impeller and nozzle assembly, welded stainless steel rotor shaft
- Integrated thermal protection and watertight terminal box contribute to better pump protection

## Technical data

### AJ-S | 55

### | 75

Max. head (m)	38	44
Max. Flow (m <sup>3</sup> /h)	4	4.5
Max. suction head (m)	9	9
Power P2 (kW)	0.55	0.75
Supply voltage	1x230V, 50Hz	1x230V, 50Hz
Protection class	IP44	IP44
Ambient temperature (°C)	40	40
Fluid temperature (°C)	40	40
Max. system pressure (bar)	4.8	4.8
Insulation class	Class B	Class B
Pump housing material	stainless steel	stainless steel
Impeller material	PPO	PPO
Cable	1.5m Length incl. protective power plug	1.5m Length incl. protective power plug

**Article No**  
**| P OP340 7151**

**Article No**  
**| P OP340 7150**

### Hydraulic characteristics

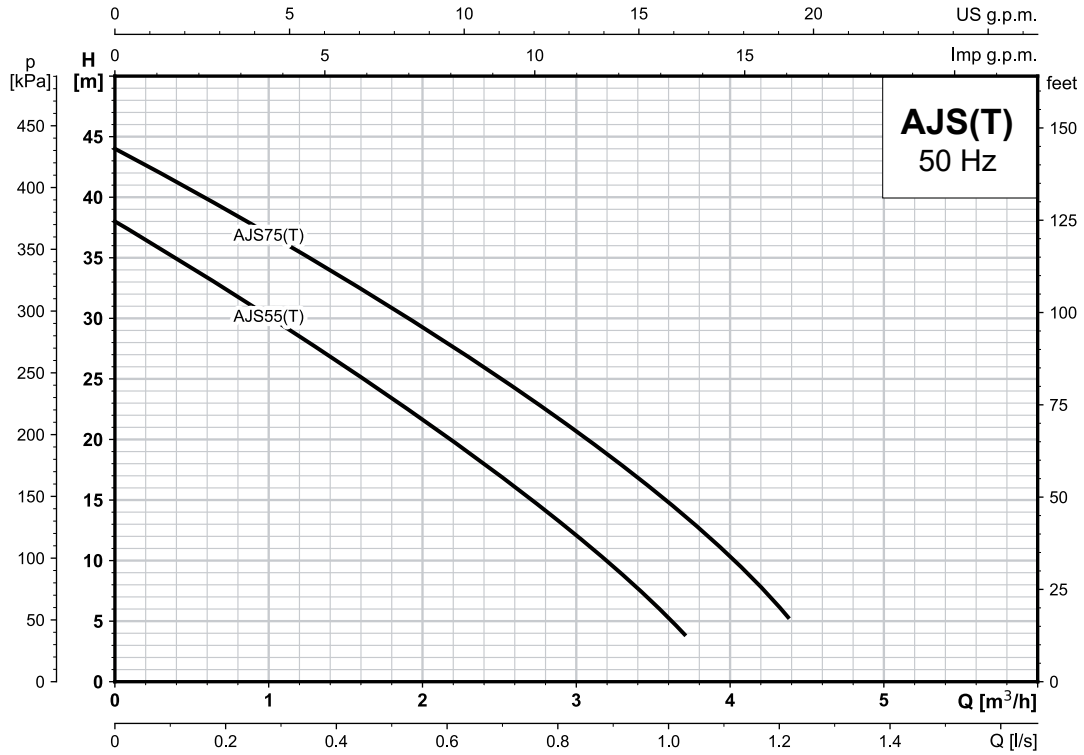

### Dimensions and Weight

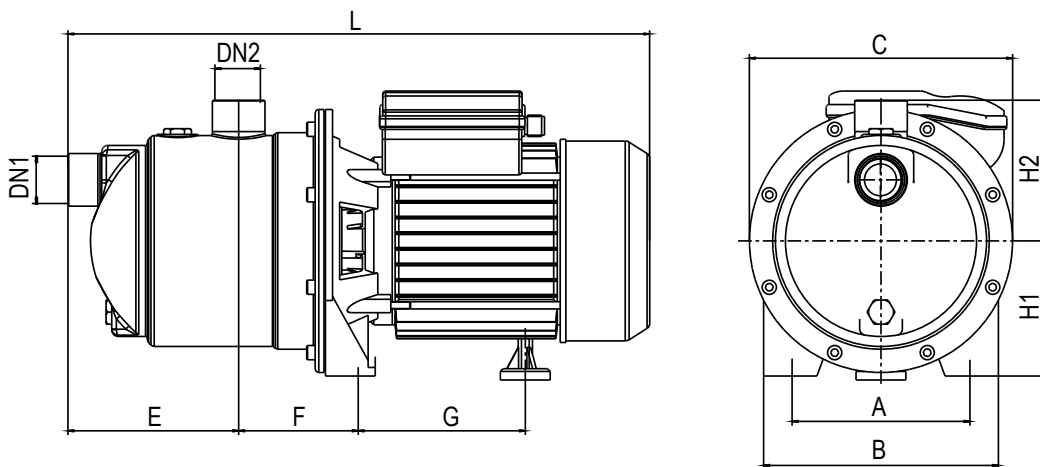

Model	Connections		Dimensions (mm)								Weight (kg)		
	DN1	DN2	A	B	C	E	F	G	L	H1	H2	N.W.	G.W.
Single-phase													
AJS55	1"	1"	125	165	185	76.5	83.5	114.5	371	95	99	8.8	9.3
AJS75	1"	1"	125	165	185	76.5	83.5	114.5	371	95	99	10.2	10.7

# ADELINO®

— WATER PUMPS —

— BY —



## WITA - Wilhelm Taake GmbH

Böllingshöfen 85 | D-32549 Bad Oeynhausen  
Tel.: +49 5734 512380 | Fax: +49 5734 1752  
[www.wita.de](http://www.wita.de) | [info@wita.de](mailto:info@wita.de)



## WITA sp. z o. o.

Zielonka, ul. Biznesowa 22 | 86-005 Białe Błota  
Tel.: +48 52 564 09 00 | Fax: +48 52 564 09 22  
[www.wita.pl](http://www.wita.pl) | [info@wita.pl](mailto:info@wita.pl)

